



...perfect for public play spaces

Inspiring playworlds
for the public area!





Inspiring playworlds for the public area!

Proved to be good for generations and preserved for you: playground-classics for all!

Completely revised - modular - flexible and versatile!

This clear concept is designed especially for public playgrounds in rural areas.

ecorino convinces through a solid manufacture, -modern design and inexpensive materials.

The modular playground concept offers you:

- Play-,climb-,slide-,sand combination
- Swinging, seesawing
- Themed play units

Supplemented by basis-products:

- Water play units and
- Playground equipment

eibe ecorino - and everything fits!

With this multifaceted and yet low-cost concept you will meet all play needs. Durable products keep the maintenance requirements and running cost on the playground low.



new system & new colour worlds 2017



Checked, tested and awarded!

These awards and test seals are the best evidence that we have the quality and philosophy in place.



...perfect for public play spaces

Classic features with contemporary look!



One brand - countless possibilities - maximum play value!

- extremely robust & inexpensive
- modernised statics and design
- latest added pedagogical value
- low maintenance
- huge selection of components and accessories
- perfect for all spatial conditions





...perfect for public play spaces

Countless module variants for your play world:

wall panels
in 120 versions

slides
3 shapes, 3 colours and
3 materials



platforms
in over 10 versions

- Unique play worlds according to your wishes
- Extremely high quality and robust materials
- Enormously weather resistant and low maintenance

- Satisfies the highest safety standards
- Expert consulting on-site

roof types and -shapes
in 15 versions

crossings
more than 16 options

Consulting. Design. Cost effective.

**CONSULTING
ON SITE**

ascents
over 45 options available

play panels
in 75 versions



NEW
from autumn
2017

New ecorino
themed play units from eibe.



These themes will be ready
for you in autumn 2017!





...perfect for public play spaces

Supreme quality



Stainless Steel
Monkey bars



Fireman's Pole in
Stainless Steel



Climbing panel HPL

House roof SW



Post SW

Steel post shoes, hot-dipped
and galvanised



Slides GFRP



● All: adapter SW,
fittings steel

ensures safe and fun play



Plastic-coated steel cable



Step HPL



Suspension bridge SW, chain hot-dip galvanized steel

Wall panel SW

Walk-through protection - Stainless steel

Step-through protection SW

Platform SW



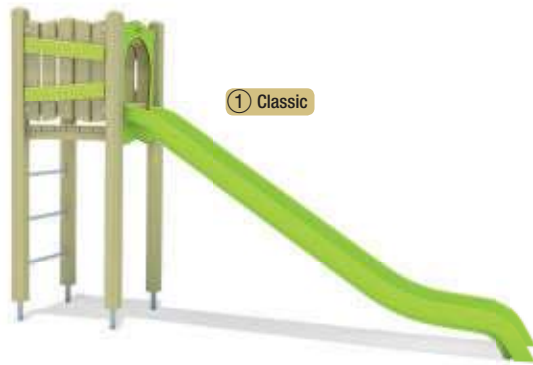

① Classic

Please order the slide separately



② Trend

Please choose your add-on slide:



A	5 40 101 101 31	GFRP	PH 145 cm
B	5 40 101 111 31	GFRP with stainless steel cover	PH 145 cm
C	5 40 101 121 00	Stainless steel	PH 145 cm

NEW



eibe ecorino
Slide ascent PH 145 Solo

Info box		
Minimum space:	7,04x3,86x3,25 m	
Free falling height:	1,45 m	
Impact protection net:	22,0 m ²	
Foundations:	5x CF or 5x PFs	

①	5 11 501 011 00	SW pi	FL 1
②	5 11 501 041 00	Larch oiled	FL 1

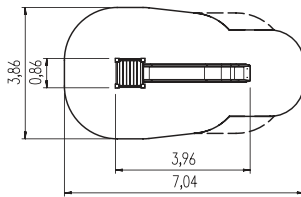
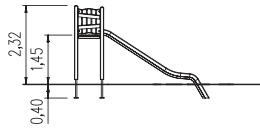

NEW



eibe ecorino
Play unit Dom, Solo

Info box		
Minimum space:	6,68x5,46x3,01 m	
Free falling height:	0,95 m	
Impact protection net:	24,0 m ²	
Foundations:	11x CF or 8x PFs	

①	5 11 502 011 00	SW pi	FL 1
②	5 11 502 041 00	Larch oiled	FL 1



② Trend

① Classic

Please order the slide separately

Please choose your add-on slide:



A	5 40 185 101 31	GFRP	PH 95 cm
B	5 40 185 111 31	GFRP with stainless steel cover	PH 95 cm
C	5 40 185 121 00	Stainless steel	PH 95 cm

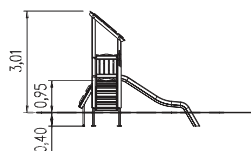
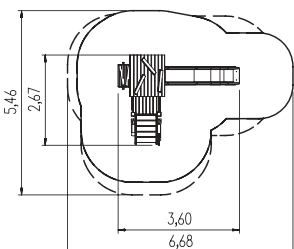

Steel posts also
available on request.



NEW



eibe ecorino
Play unit Monte Viso, Solo

Info box

Minimum space:	7,10x8,19x3,71 m
Free falling height:	1,45 m
Impact protection net:	38,5 m ²
Foundations:	12x CF or 12x PFs

① 5 11 503 011 00	SW pi	FL 1
② 5 11 503 041 00	Larch oiled	FL 1

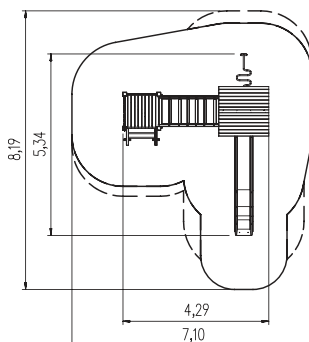
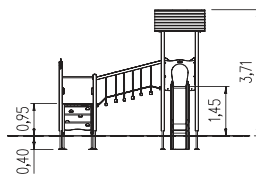

① Classic

Please choose your add-on slide:



A 5 40 101 101 31	GFRP	PH 145 cm
B 5 40 101 111 31	GFRP with stainless steel cover	PH 145 cm
C 5 40 101 121 00	Stainless steel	PH 145 cm

Steel posts also
available on request.



② Trend



Please order the
slide separately



① Classic

NEW



eibe ecorino
Play unit Eiger, Solo

Info box

Minimum space:	7,80x5,09x3,51 m
Free falling height:	1,73 m
Impact protection net:	27,0 m ²
Foundations:	10x CF or 9x PFs

① 5 11 504 011 00	SW pi	FL 1
② 5 11 504 041 00	Larch oiled	FL 1

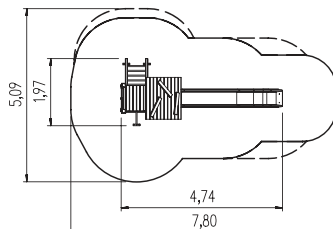
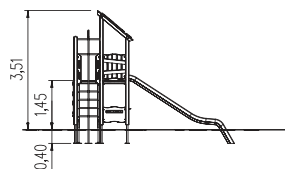

Please choose your add-on slide:



A 5 40 101 101 31	GFRP	PH 145 cm
B 5 40 101 111 31	GFRP with stainless steel cover	PH 145 cm
C 5 40 101 121 00	Stainless steel	PH 145 cm



NEW



eibe ecorino
Play unit Elbrus, Solo

Info box

Minimum space:	10,02x6,83x3,75 m
Free falling height:	2,20 m
Impact protection net:	42,0 m ²
Foundations:	17x CF or 16x PFs

① 5 11 508 011 00	SW pi	FL 1
② 5 11 508 041 00	Larch oiled	FL 1

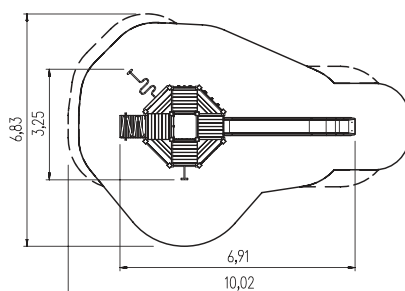
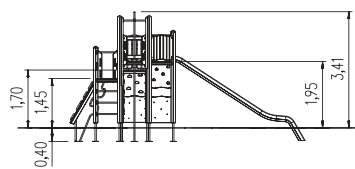

Please choose your add-on slide:

A	5 40 102 101 31	GFRP	PH 195 cm
B	5 40 102 111 31	GFRP with stainless steel cover	PH 195 cm
C	5 40 102 121 00	Stainless steel	PH 195 cm





NEW



eibe ecorino
Play unit Makalu, Solo

Info box

Minimum space:	10,82x6,78x3,96 m
Free falling height:	1,95 m
Impact protection net:	50,5 m ²
Foundations:	18x CF or 17x PFs + 1x CF

- ① 5 11 509 011 00 **SW pi** **FL 1**
- ② 5 11 509 041 00 **Larch oiled** **FL 1**

Please choose your add-on slide:

5 58 666 101 31 **GFRP**



PH 195 cm

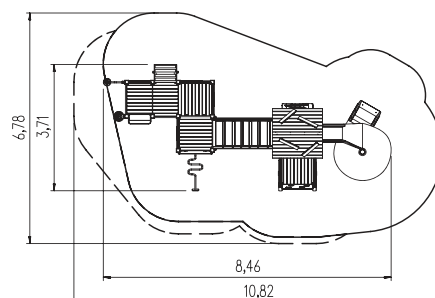
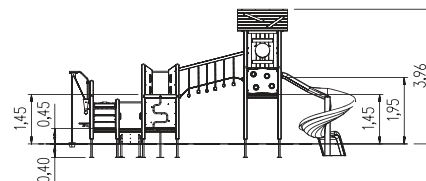

Steel posts also
available on request.

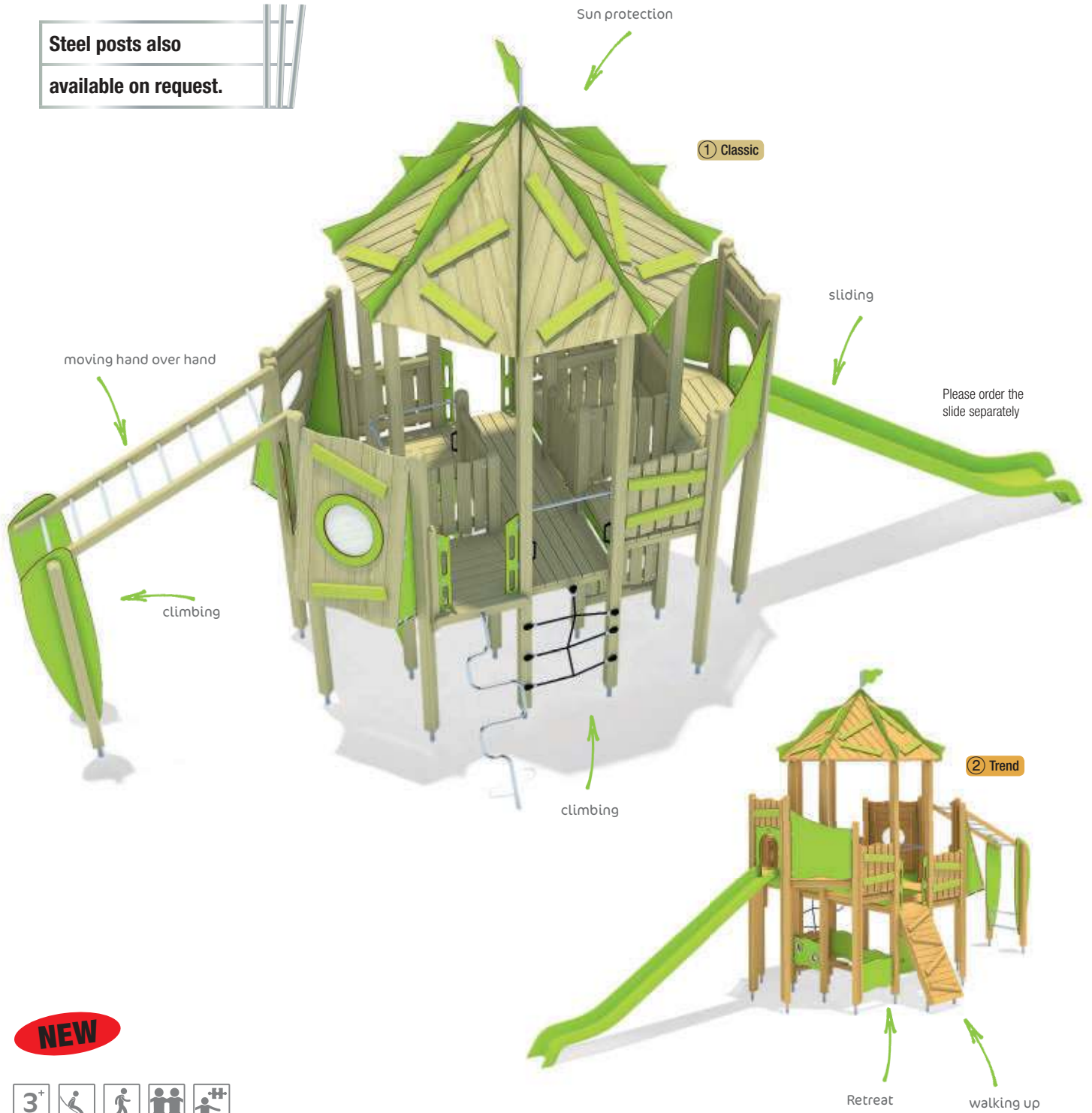

NEW



eibe ecorino
Play unit Kilimandscharo, Solo

Info box	
Minimum space:	13,20x6,99x5,20 m
Free falling height:	2,85 m
Impact protection net:	60,0 m ²
Foundations:	26x CF or 25x PFs

- ① 5 11 510 011 00 SW pi FL 1
- ② 5 11 510 041 00 Larch oiled FL 1

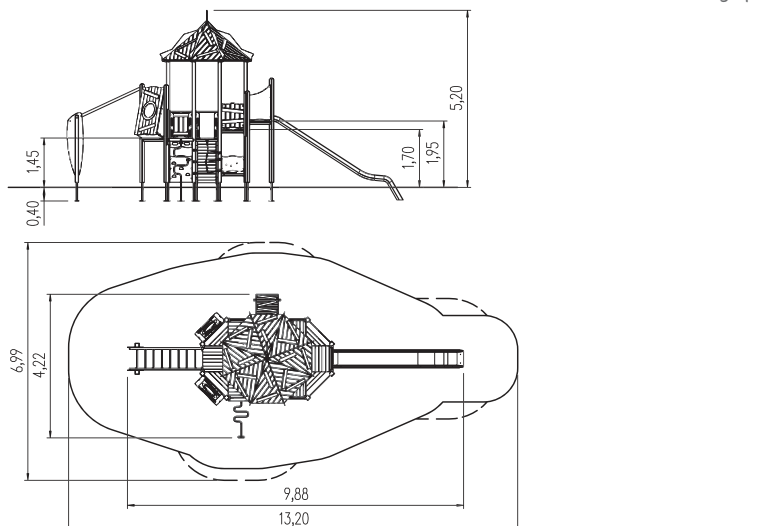

Please choose your add-on slide:

- A 5 40 102 101 31 GFRP PH 195 cm
- B 5 40 102 111 31 GFRP with stainless steel cover PH 195 cm
- C 5 40 102 121 00 Stainless steel PH 195 cm



NEW

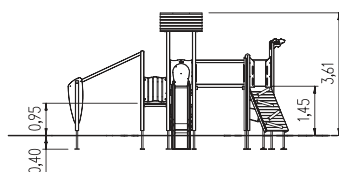

eibe ecorino
Play unit Belavista, Solo

Info box

Minimum space:	9,66x7,93x3,61 m
Free falling height:	2,35 m
Impact protection net:	46,0 m ²
Foundations:	14x CF or 14x PFs

- ① 5 11 505 011 00 SW pi FL 1
- ② 5 11 505 041 00 Larch oiled FL 1

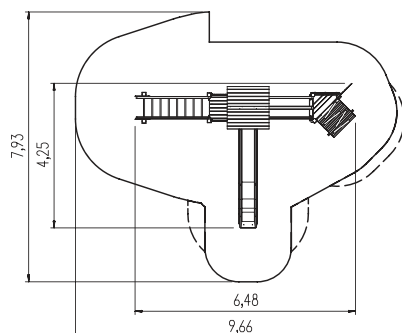

Please choose your add-on slide:



- A 5 40 101 101 31 GFRP PH 145 cm
- B 5 40 101 111 31 GFRP with stainless steel cover PH 145 cm
- C 5 40 101 121 00 Stainless steel PH 145 cm

Steel posts also
available on request.



NEW



eibe ecorino
Play unit Mont Blanc

Info box

Minimum space:	5,85x5,36x4,01 m
Free falling height:	2,20 m
Impact protection net:	23,0 m ²
Foundations:	13x CF or 11x PFs

- ① 5 11 506 011 00 SW pi FL 1
- ② 5 11 506 041 00 Larch oiled FL 1

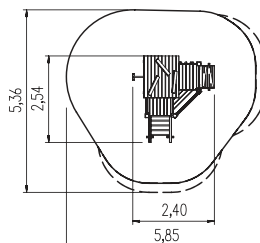
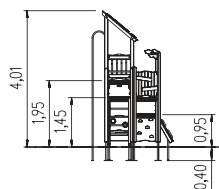



NEW



eibe ecorino
Play unit Kibo, Solo

Info box

Minimum space:	12,80x9,93x4,50 m
Free falling height:	1,45 m
Impact protection net:	74,5 m ²
Foundations:	23x CF or 23x PFs

① 5 11 507 011 00	SW pi	FL 1
② 5 11 507 041 00	Larch oiled	FL 1

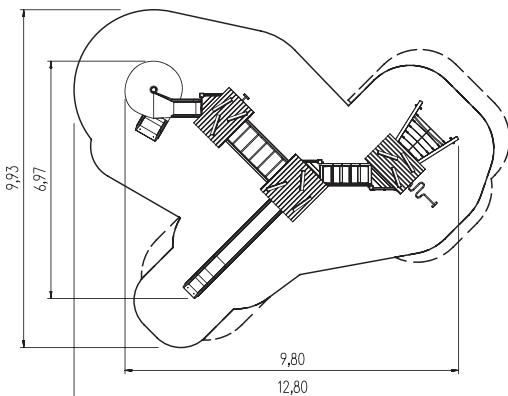
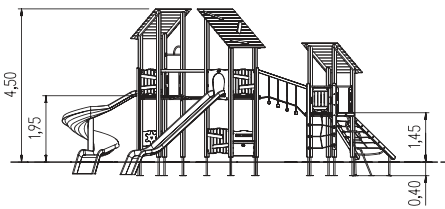

Please choose your add-on slide:



A 5 40 102 101 31	GFRP	PH 195 cm
B 5 40 102 111 31	GFRP with stainless steel cover	PH 195 cm
C 5 40 102 121 00	Stainless steel	PH 195 cm
D 5 58 666 101 31	GFRP	PH 195 cm

Steel posts also
available on request.



4 Playboards to discover

Please order the
slide PH 145 cm
separately



2 Trend

Please order the spiral tube
slide 360° separately!

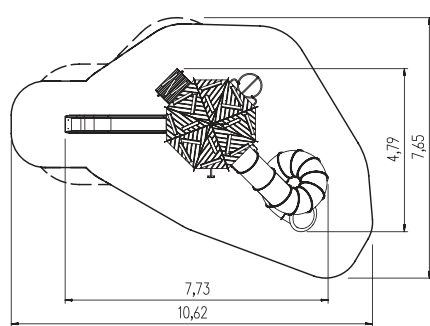
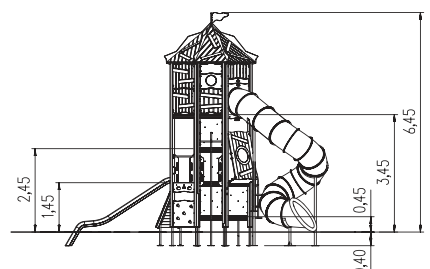

NEW



eibe ecorino
Play unit Mount Everest, Solo

Info box

Minimum space:	10,62x7,65x6,45 m
Free falling height:	2,45 m
Impact protection net:	50,0 m ²
Foundations:	6x CF or 2x PFs + 4x CF

① 5 11 512 011 00	SW pi	FL 1
② 5 11 512 041 00	Larch oiled	FL 1

Please choose your add-on slides:



A 5 40 101 101 31	GFRP	PH 145 cm
B 5 40 101 111 31	GFRP with stainless steel cover	PH 145 cm
C 5 40 101 121 00	Stainless steel	PH 145 cm

Please choose your spiral
tube slide 360°.



D 5 40 121 101 31	GFRP	Spiraled left	PH 345 cm
E 5 40 114 121 00	Stainless steel		PH 345 cm
F 5 40 122 101 31	GFRP	Spiraled right	PH 345 cm
G 5 40 115 121 00	Stainless steel		PH 345 cm
H 5 40 199 150 31	HPL iguana	Climb over protection	



...perfect for public play spaces

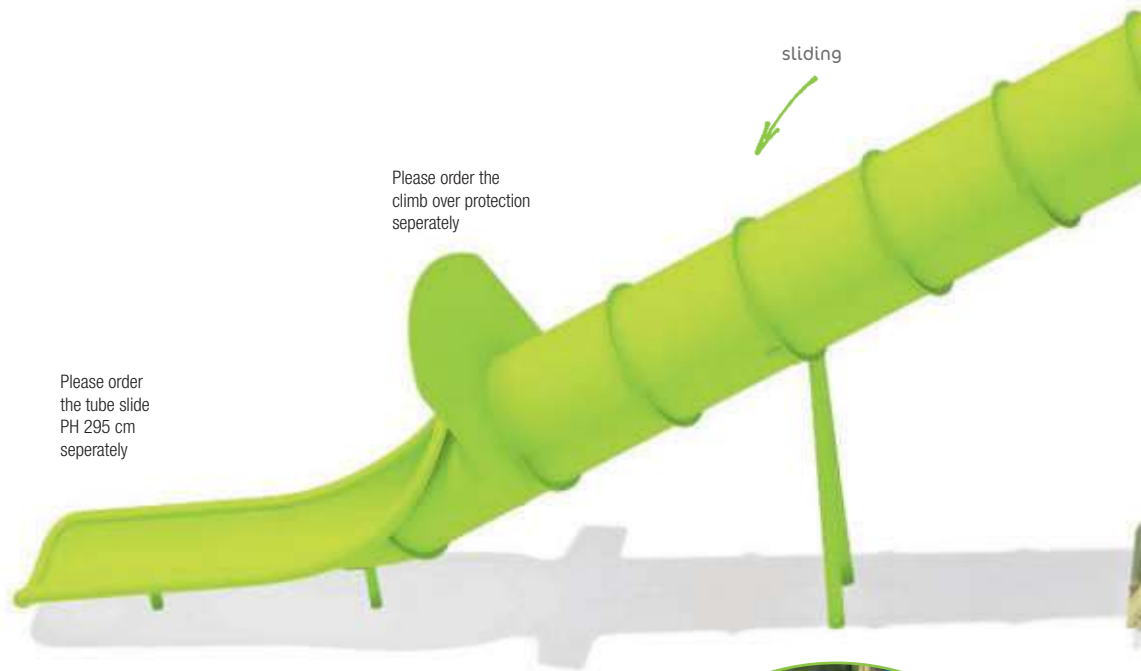

Please order the climb over protection separately

Please order the tube slide PH 295 cm separately

NEW



eibe ecorino
Play unit Denali, Solo

Info box

Minimum space:	14,05x13,48x4,96 m
Free falling height:	2,95 m
Impact protection net:	106,5 m ²
Foundations:	32x CF or 28x PFs + 3x CF

- ① 5 11 511 011 00 SW pi FL 1
- ② 5 11 511 041 00 Larch oiled FL 1

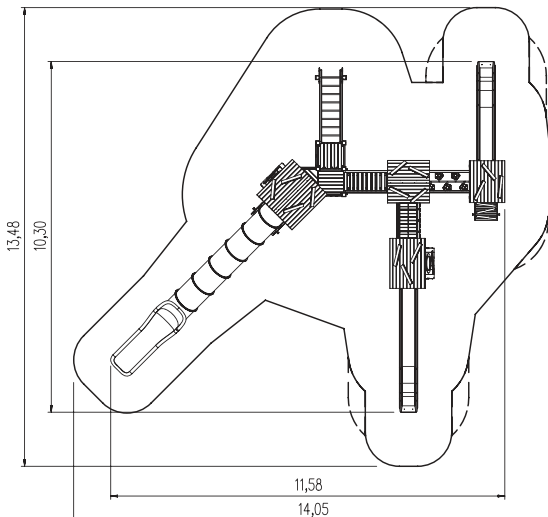
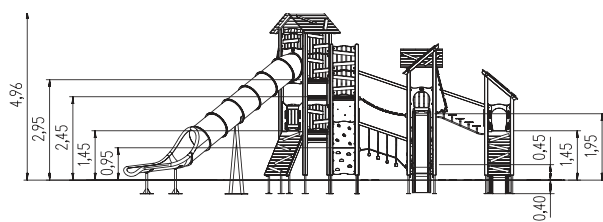

Please order PH 145 cm & PH 195 cm slides separately

Please choose your add-on slides:

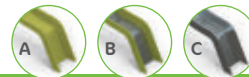

A	5 40 101 101 31	GFRP	PH 145 cm
B	5 40 101 111 31	GFRP with stainless steel cover	PH 145 cm
C	5 40 101 121 00	Stainless steel	PH 145 cm
A	5 40 102 101 31	GFRP	PH 195 cm
B	5 40 102 111 31	GFRP with stainless steel cover	PH 195 cm
C	5 40 102 121 00	Stainless steel	PH 195 cm

Please choose your tube slide



D	5 40 116 101 31	GFRP	PH 295 cm
E	5 40 108 121 00	Stainless steel	PH 295 cm
F	5 40 199 150 31	HPL iguana	Climb over protection

Sun protection

Steel posts also
available on request.

① Classic

moving hand over hand

Sun protection

Sun protection

climbing

creche area

walking up

② Trend

balancing

walking up



② Trend



eibe ecorino
Play house Bergsee

Info box

Minimum space:	6,30x5,55x3,46 m
Free falling height:	1,45 m
Impact protection net:	26,5 m ²
Foundations:	13x CF or 12x PFs

- ① 5 11 513 011 00 SW pi FL 1
- ② 5 11 513 041 00 Larch oiled FL 1

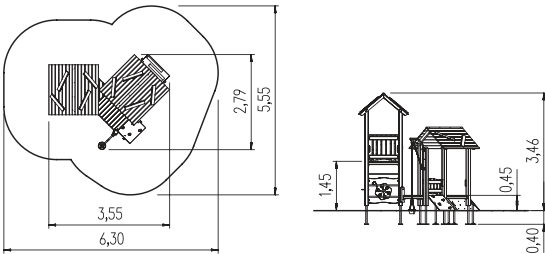

① Classic



Steel posts also
available on request.



NEW



eibe ecorino
Play house Alpenrose

Info box

Minimum space:	5,32x4,81x3,75 m
Free falling height:	1,73 m
Impact protection net:	19,0 m ²
Foundations:	4x CF or 3x PFs + 1x CF

- ① 5 11 514 011 00 SW pi FL 1
- ② 5 11 514 041 00 Larch oiled FL 1

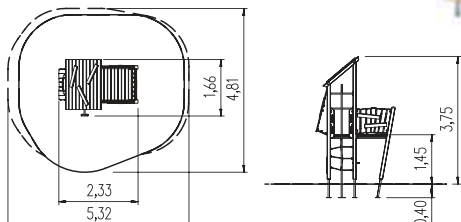

② Trend



① Classic





Galvanised swing joint!



**eibe ecorino Double Swing
with Nest seat Ø 100 cm**

Info box

Minimum space:	333x800x368 cm
Free falling height:	188 cm
Impact protection net:	20 m ²
Foundations:	4x CF

5 15 002 133 00 Steel FL 3

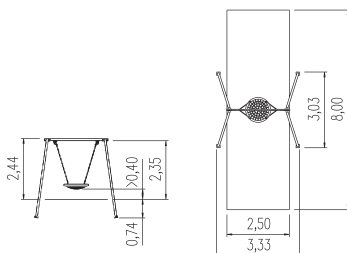



Swing beam height 2,45 m!
The best swing joint!

Swing joint galvanised.
Swing chain stainless steel.

Top price!



eibe ecorino Double swing with swing seats

Info box

Minimum space:	333x800x330 cm
Free falling height:	137 cm
Impact protection net:	23,5 m ²
Foundations:	4x CF

5 15 001 133 00 **Steel** **FL 3**

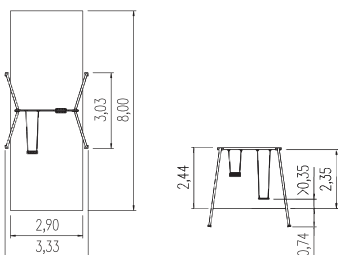

① Classic



② Trend

NEW



eibe playo Quadruple swing with nest seat & swing seats Condor

Info box

Minimum space:	800x643x368 cm
Free falling height:	188 cm
Impact protection net:	47 m ²
Foundations:	6x CF or 6x PFs + 6x CF

① 5 10 170 011 00	SW pi	FL 1
② 5 10 170 041 00	Oiled Larch	FL 1

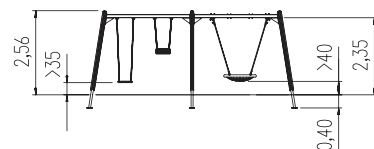
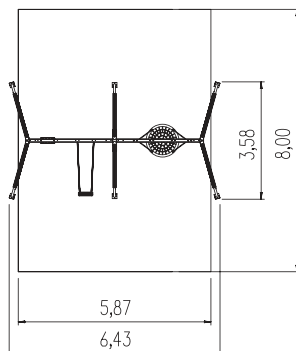

Tailor your desired swing individually!



eibe playo Double swing frame Condor

5 10 074 011 00	SW pi	FL 1
5 10 074 041 00	Larch oiled	FL 1

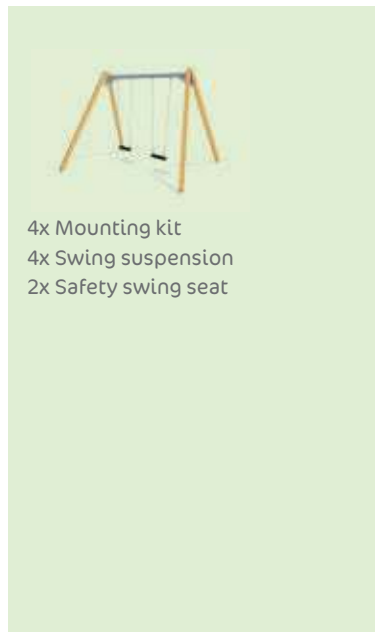

- 4x Mounting kit
- 4x Swing suspension
- 2x Safety swing seat



eibe playo Triple swing frame Condor

5 10 150 011 00	SW pi	FL 1
5 10 150 041 00	Larch oiled	FL 1

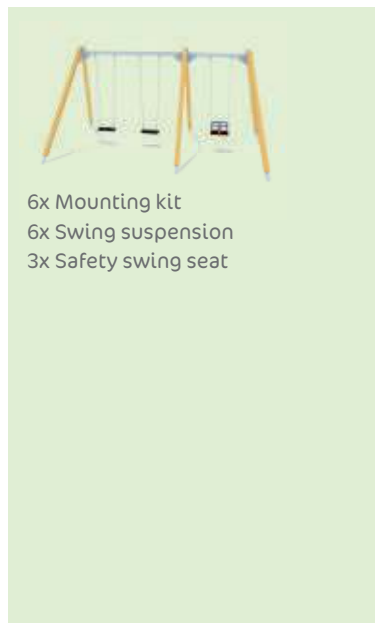

- 6x Mounting kit
- 6x Swing suspension
- 3x Safety swing seat

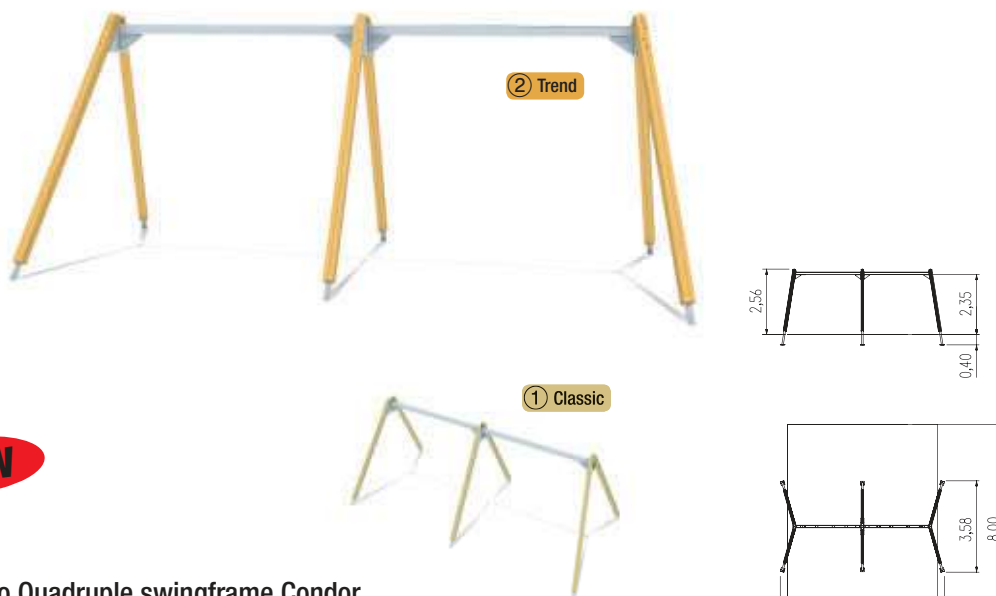

eibe playo Quadruple swingframe Condor

5 10 160 011 00	SW pi	FL 1
5 10 160 041 00	Oiled Larch	FL 1

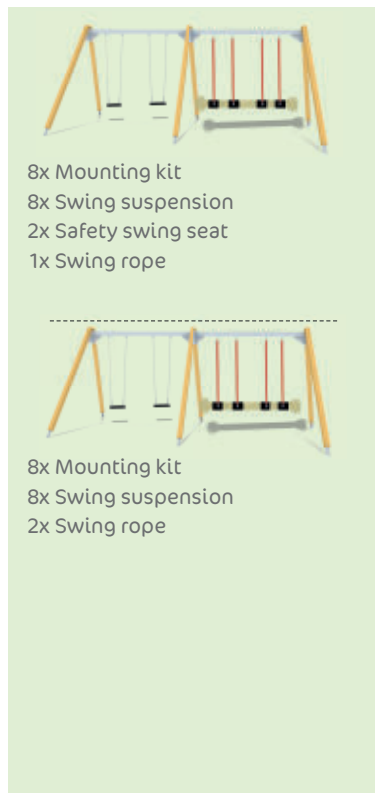

- 8x Mounting kit
- 8x Swing suspension
- 2x Safety swing seat
- 1x Swing rope

- 8x Mounting kit
- 8x Swing suspension
- 2x Swing rope

NEW



2x Mounting kit
2x Cardan joint
1x Nest seat



4x Mounting kit
4x Swing suspension
1x Swing rope

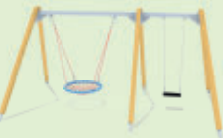

4x Mounting kit
2x Swing suspension
2x Cardan joint
1x Safety swing seat
1x Nest seat

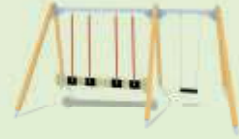

4x Mounting kit
4x Swing suspension
2x Cardan joint
1x Safety swing seat
1x Swing rope



6x Mounting kit
4x Swing suspension
2x Cardan joint
2x Safety swing seat
1x Nest seat



8x Mounting kit
8x Swing suspension
4x Safety swing seat

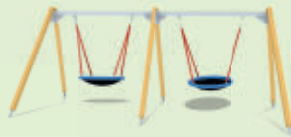

4x Mounting kit
4x Cardan joint
2x Nest seat



Swing Rope

5 63 225 0 PP Fentex rope -

All seats are PAH-free



Toddlers' Swing seat Color

5 63 195 0 Steel rope -



Nest Seat rubber linked mat Ø 120 cm

5 55 048 0 Cable ring, steel cable net mesh, rubber fabric -



Nest seat, steel cable net mesh Ø 100 cm

5 55 052 0 Steel, polyester-coated steel cable -

Nest seat, steel cable net mesh Ø 120 cm

5 55 627 0 Steel FL 2

The eibe swing suspension is galvanised or stainless steel and is mounted with two screws.



Swing Suspension

5 63 011 0 Steel -
5 55 001 120 00 Stainless steel -



Mounting set for Swing beam

5 63 924 0



Safety Swing Seat for Small Children

5 63 203 0 Steel, rubber -



Safety Swing Seat

5 63 207 0 Steel, rubber -
5 55 003 120 00 Stainless steel, rubber -



Cardan joint steel

5 63 040 0 Steel -
5 55 002 120 00 Stainless steel -



Safety chain for cardan joint

5 63 214 0 Steel -
5 55 006 120 00 Stainless steel -



Safety Swing Seat, Broad

5 63 204 0 Steel, rubber -
5 55 004 120 00 Stainless steel, rubber -

the
'need for
speed' in every
playground



eibe ecorino
Aerial cableway Jota 20

Info box

Minimum space:	2850x584x371 cm
Free falling height:	-
Impact protection net:	76,2 m ²
Foundations:	6x CF

5 15 034 133 00 Steel FL 3

eibe ecorino
Aerial cableway Jota 30

Info box

Minimum space:	3842x580x365 cm
Free falling height:	-
Impact protection net:	107 m ²
Foundations:	6x CF

5 15 035 133 00 Steel FL 3

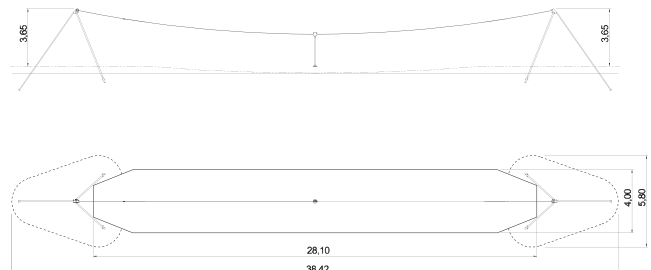
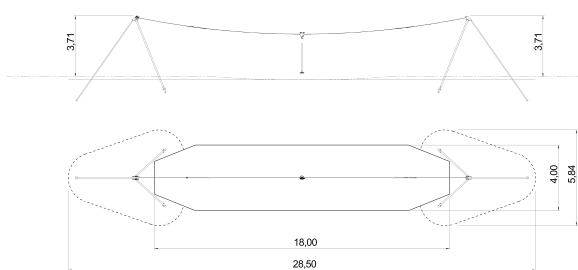

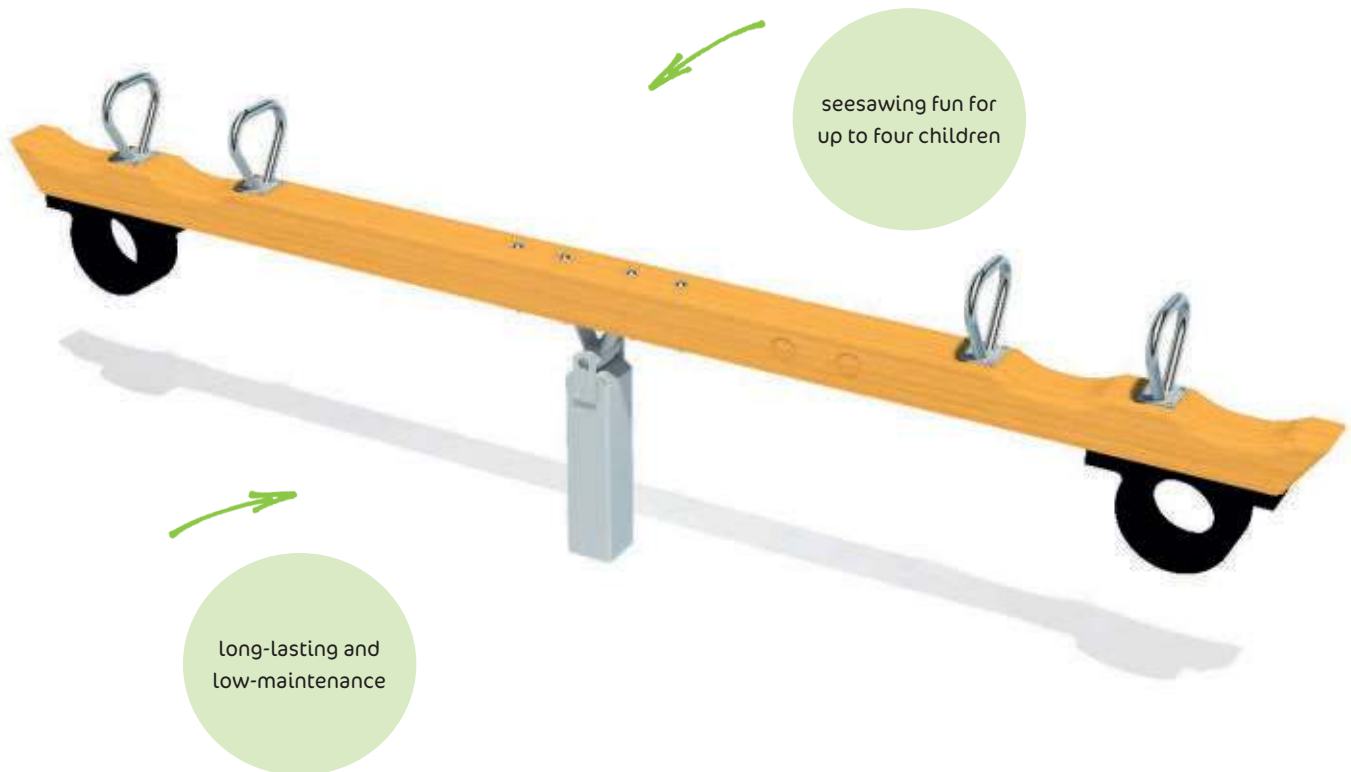

seesawing fun for up to four children

long-lasting and low-maintenance

Up and down on the eibe ecorino beam seesaw.



eibe ecorino Beam see-saw, four-seater

Info box	
Minimum space:	660x314x303 cm
Free falling height:	123 cm
Impact protection net:	12,3 m ²
Foundations:	1x CF

- ① 5 15 022 013 00 SW pi FL 3
- ② 5 15 022 043 00 Larch oiled FL 3

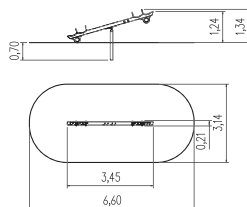



eibe Horse spring rocker

Info box

Minimum space:	410x350x238 cm
Free falling height:	58 cm
Impact protection net:	7 m ²
Foundations:	1x 5591600 + 1x CF or 1x 5632100 + 1x CF

5 67 243 0 Laminated timber, MDF **FL 3**

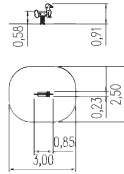

eibe Fox spring rocker

Info box

Minimum space:	415x350x238 cm
Free falling height:	58 cm
Impact protection net:	7 m ²
Foundations:	1x 5591600 + 1x CF or 1x 5632100 + 1x CF

5 67 241 0 Laminated timber, MDF **FL 3**

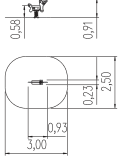

Animal-shaped spring rockers – make you jump with delight!

ORDER SEPARATELY

Ground anchor 1 for mounting: 5632100



eibe Goose spring rocker

Info box

Minimum space:	410x350x238 cm
Free falling height:	58 cm
Impact protection net:	7 m ²
Foundations:	1x 5591600 + 1x CF or 1x 5632100 + 1x CF

5 67 242 0 Laminated timber, MDF **FL 3**

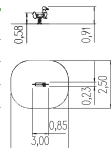

eibe Pony spring rocker

Info box

Minimum space:	300x250x238 cm
Free falling height:	58 cm
Impact protection net:	7 m ²
Foundations:	1x 5591600 + 1x CF or 1x 5632100 + 1x CF

5 67 013 0 Laminated timber, MDF **FL 3**

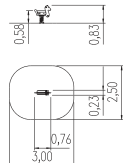



eibe Little Beetle spring rocker

Info box

Minimum space:	349x349x226 cm
Free falling height:	41 cm
Impact protection net:	6,5 m ²
Foundations:	1x 5591600 + 1x CF or 1x 5632100 + 1x CF

5 59 809 0 **Steel, PE** **FL 3**

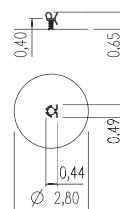

eibe spring rocker Butterfly

Info box

Minimum space:	280x250x221 cm
Free falling height:	40 cm
Impact protection net:	7 m ²
Foundations:	1x 5591600 + 1x CF or 1x 5632100 + 1x CF

5 67 018 0 **Steel, PE** **FL 3**

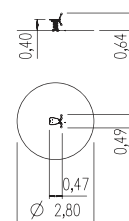

eibe Snake spring rocker

Info box

Minimum space:	Ø 250x220 cm
Free falling height:	40 cm
Impact protection net:	5 m ²
Foundations:	1x 5591600 + 1x CF or 1x 5632100 + 1x CF

5 67 125 0 **Steel, PE** **FL 3**

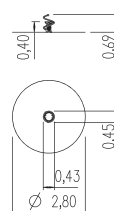



more fun
with water



NEW



Water play unit River

Info box

Minimum space:	602x414x200 cm
Free falling height:	70 cm
Impact protection net:	12 m ²
Foundations:	11x CF or 11x PFs

5 66 436 120 00 Stainless steel FL 1

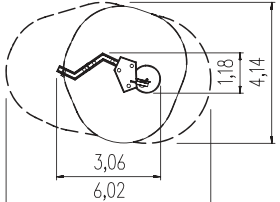

- Please choose one of these pumps:
- | | | |
|----------|--|------------------------|
| A | | Stainless steel |
| B | | Grey-cast |
- A 5 66 290 0 B 5 57 051 0**



NEW



Water play unit Nevada

Info box

Minimum space:	464x527x200 cm
Free falling height:	70 cm
Impact protection net:	12 m ²
Foundations:	13x CF or 13x PFs

5 66 438 120 00 Stainless steel FL 1

Please choose one of these pumps:



A 5 66 290 0	Stainless steel
B 5 57 051 0	Grey-cast

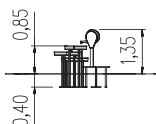
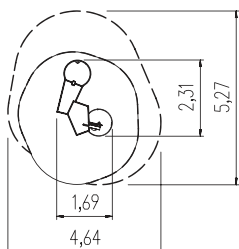



NEW



Pump platform

5 66 440 120 00 Stainless steel



Valve basin 1 valve

5 66 421 120 00 Stainless steel



Valve basin 2 valves

5 66 423 120 00 Stainless steel

Accessories for individual combinations



Valve basin pentagonal 1 valve

5 66 427 120 00 Stainless steel



Valve basin square 1 valve

5 66 425 120 00 Stainless steel



Water channel curved left

5 66 429 120 00 Stainless steel



Water channel curved right

5 66 430 120 00 Stainless steel



Stainless steel support 20 cm

5 66 435 120 00 Stainless steel FL 1

Stainless steel support 56 cm

5 66 433 120 00 Stainless steel FL 1

Stainless steel support 74 cm

5 66 431 120 00 Stainless steel FL 1

Stainless steel support 38 cm

5 66 434 120 00 Stainless steel FL 1

Stainless steel support 65 cm

5 66 432 120 00 Stainless steel FL 1

Triangular sun awning, retractable

Mini-Vario sun awning in triangular form, extract- and retractable on one side.

Size: Area: 17,5 qm, single-sided roll-out 5 m, length 7 m

5 60 227 50

Size: Area: 21 qm, single-sided roll-out 6 m, length 7 m

5 60 228 50

Size: Area: 28 qm, single-sided roll-out 8 m, length 7 m

5 60 229 50

Consulting. Design. Cost effective.

**CONSULTING
ON SITE**



The posts are made from hot-dip galvanised steel with plastic cap. The awning can be adjusted manually via a cable pull with a winch that rolls up the sail automatically. Winding roll of the sun awning Ø 90 from an aluminium channel rail. The sun awning is made from the mesh fabric

"Soltis 86" (100% PES) with PVC coating, tearproof and hard-wearing, UV-resistant, with a very high 86% sun protection factor. Special sizes are possible. A winding roll with electric motor is available upon request.

Diamond-shaped sun awning, retractable

Mini-Vario sun awning, diamond-shaped, extract- and retractable on both sides.

Size: Area: 20 qm, double-sided roll-out 5 m, length 4 m

5 60 230 50

Size: Area: 30 qm, double-sided roll-out 6 m, length 5 m

5 60 231 50

Size: Area: 48 qm, double-sided roll-out 8 m, length 6 m

5 60 232 50



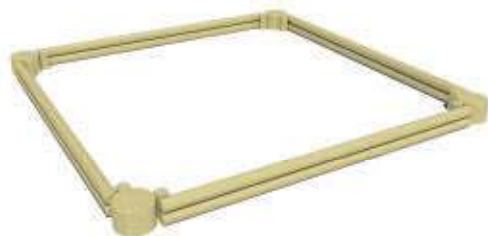

eibe acqua Palisade sandpit, square

5 59 087 0 SW pi -

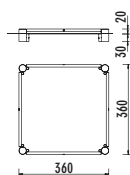

eibe acqua Palisade sandpit, square

5 59 084 0 SW pi -

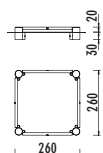

eibe acqua Palisade sandpit, hexagon

5 59 089 0 SW pi -

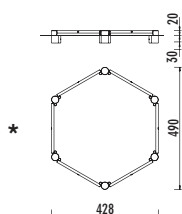

The "Soft" sandpit sets stand out due to their flexible shape which can be altered as desired using the individual granulated elements made of recyclable rubber material.

The dimensions of one element are:

L= 116 cm, H=30 cm and D= 15 cm (where the centre-to-centre distance of the aluminium attachment posts is 100 cm).

eibe acqua Sandpit set "Soft" 10 elements

5 59 143 0 Rubber -



eibe acqua Sandpit set "Soft" 6 elements

5 59 142 0 Rubber -



eibe acqua Sandpit set "Soft" 1 element

5 59 141 0 Rubber -



Low installation height

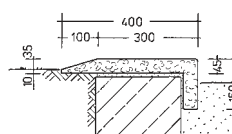

eibe acqua Sand pit safety surround

5 59 091 3 Rubber granulate -



ORDER SEPARATELY

Impact-attenuating tile glue

5 63 033 0 PUR-adhesive -



① Classic



② Trend



**eibe Slide
platform PH 45 cm**

Info box		
Minimum space:	4,33x3,86x2,25 m	
Free falling height:	0,45 m	
Impact protection net:	-	
Foundations:	6x CF or 5x PFs	

- ① 5 11 036 011 10 SW pi FL 1
- ② 5 11 036 041 10 Larch oiled FL 1

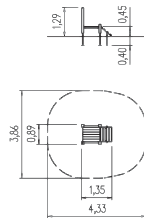

① Classic



② Trend



**eibe Slide
platform PH 95 cm**

Info box		
Minimum space:	4,28x3,86x2,75 m	
Free falling height:	0,95 m	
Impact protection net:	13,5 m ²	
Foundations:	6x CF or 5x PFs	

- ① 5 11 037 011 10 SW pi FL 1
- ② 5 11 037 041 10 Larch oiled FL 1

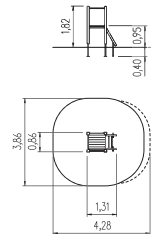

① Classic



② Trend



**eibe broad
Slide platform PH 45 cm**

Info box		
Minimum space:	4,10x4,91x2,25 m	
Free falling height:	0,45 m	
Impact protection net:	-	
Foundations:	6x CF or 5x PFs	

- ① 5 11 038 011 00 SW pi FL 1
- ② 5 11 038 041 00 Larch oiled FL 1

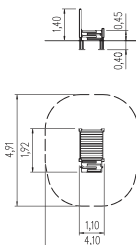

① Classic



② Trend



**eibe broad
Slide platform PH 95 cm**

Info box		
Minimum space:	4,10x4,44x2,75 m	
Free falling height:	0,95 m	
Impact protection net:	16,5 m ²	
Foundations:	4x CF or 4x PFs	

- ① 5 11 039 011 00 SW pi FL 1
- ② 5 11 039 041 00 Larch oiled FL 1

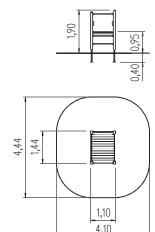

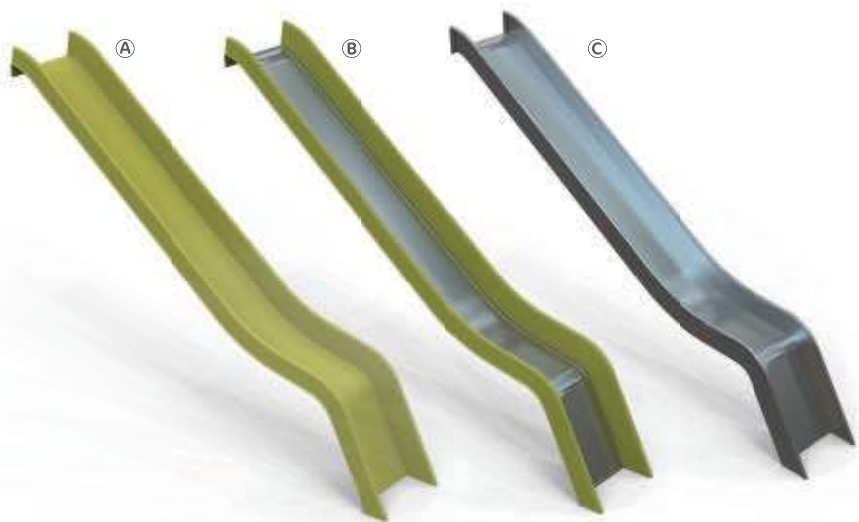

Add-on slides PH 60 cm

Info box

Minimum space:	310x354x76 cm
Free falling height:	60 cm
Impact protection net:	11 m ²
Foundations:	1x CF or 1x PF

- (A) 5 40 186 101 31 GFRP FL 1**
- (B) 5 40 186 111 31 GFRP with stainless steel cover FL 1**
- (C) 5 40 186 121 00 Stainless steel FL 1**

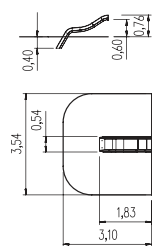

Top sliding fun on every type of slide!

Add-on slides PH 95 cm

Info box

Minimum space:	394x354x111 cm
Free falling height:	95 cm
Impact protection net:	11 m ²
Foundations:	1x CF or 1x PF

- (A) 5 40 185 101 31 GFRP FL 1**
- (B) 5 40 185 111 31 GFRP with stainless steel cover FL 1**
- (C) 5 40 185 121 00 Stainless steel FL 1**

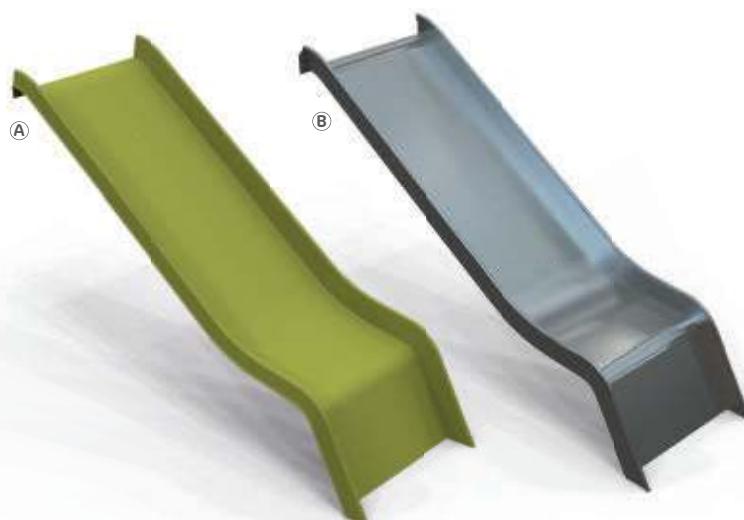
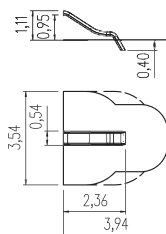

Add-on slides PH 145 cm

Info box

Minimum space:	472x354x325 cm
Free falling height:	145 cm
Impact protection net:	14 m ²
Foundations:	1x CF or 1x PFs

- (A) 5 40 101 101 31 GFRP FL 1**
- (B) 5 40 101 111 31 GFRP with stainless steel cover FL 1**
- (C) 5 40 101 121 00 Stainless steel FL 1**

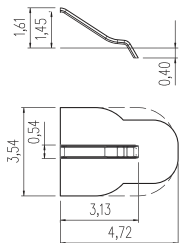

Add-on slides wide, PH 145 cm

Info box

Minimum space:	472x414x325 cm
Free falling height:	145 cm
Impact protection net:	17 m ²
Foundations:	1x CF or 1x PFs

- (A) 5 40 104 101 31 GFRP FL 1**
- (B) 5 40 104 121 00 Stainless steel FL 1**

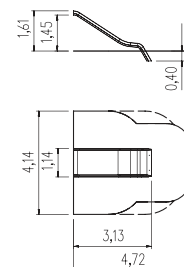

Add-on slides PH 195 cm

Info box

Minimum space:	544x418x370 cm
Free falling height:	195 cm
Impact protection net:	18 m ²
Foundations:	1x CF or 1x PFs

- (A) 5 40 102 101 31 GFRP FL 1**
- (B) 5 40 102 111 31 GFRP with stainless steel cover FL 1**
- (C) 5 40 102 121 00 Stainless steel FL 1**

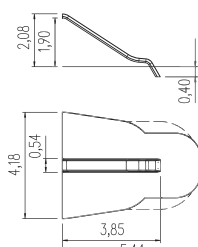

Add-on slides wide, PH 195 cm

Info box

Minimum space:	544x474x370 cm
Free falling height:	195 cm
Impact protection net:	21 m ²
Foundations:	1x CF or 1x PFs

- (A) 5 40 105 101 31 GFRP FL 1**
- (B) 5 40 105 121 00 Stainless steel FL 1**

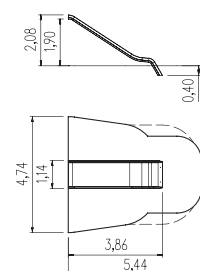



Design your slide according to your requirements

NEW

Consulting. Design. Cost effective.

CONSULTING ON SITE

- red _26
- grey _22
- RAL iguana _31

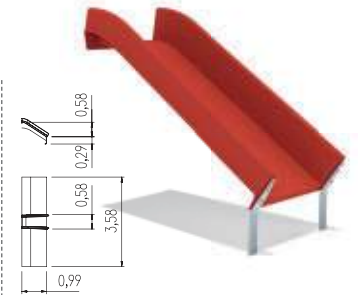

Hill slide entry plate

5 40 187 101 26	GFRP red	FL3
5 40 187 101 22	GFRP grey	FL3
5 40 187 101 31	GFRP Iguana	FL3

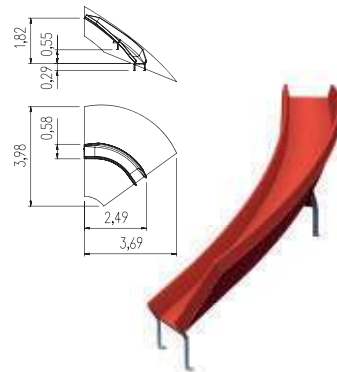

Hill slide curved right

5 40 191 101 26	GFRP red	FL3
5 40 191 101 22	GFRP grey	FL3
5 40 191 101 31	GFRP Iguana	FL3

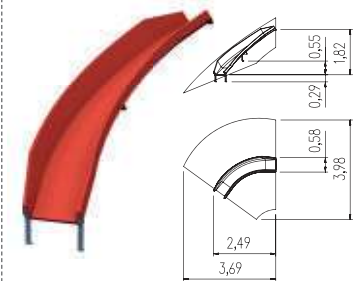

Hill slide curved left

5 40 190 101 26	GFRP red	FL3
5 40 190 101 22	GFRP grey	FL3
5 40 190 101 31	GFRP Iguana	FL3

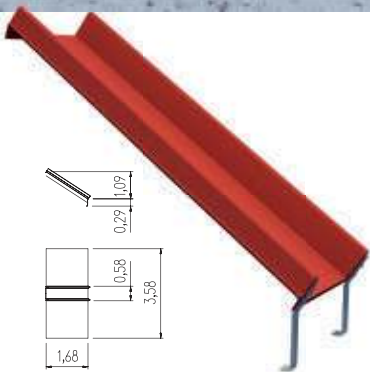

Hill slide straight 200cm

5 40 189 101 26	GFRP red	FL3
5 40 189 101 22	GFRP grey	FL3
5 40 189 101 31	GFRP Iguana	FL3

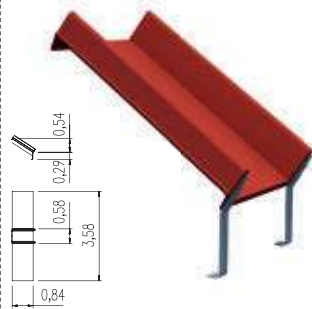

Hill slide straight 100cm

5 40 188 101 26	GFRP red	FL3
5 40 188 101 22	GFRP grey	FL3
5 40 188 101 31	GFRP Iguana	FL3

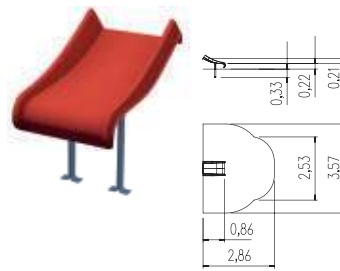

Hill slide short end

5 40 193 101 26	GFRP red	FL3
5 40 193 101 22	GFRP grey	FL3
5 40 193 101 31	GFRP Iguana	FL3

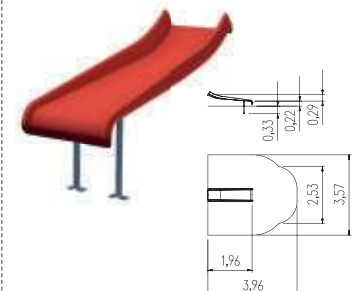

Hill slide long end

5 40 192 101 26	GFRP red	FL3
5 40 192 101 22	GFRP grey	FL3
5 40 192 101 31	GFRP Iguana	FL3

NEW

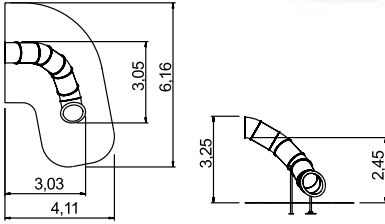

Spiral slide 120 degrees spiral right PH 245 cm

Info box

Minimum space:	411x616x425 cm
Free falling height:	30 cm
Impact protection net:	19,0 m ²
Foundations:	2x CF

5 40 117 101 26	GFRP red	FL 3
5 40 117 101 22	GFRP gray	FL 3
5 40 117 101 31	GFRP iguana	FL 3

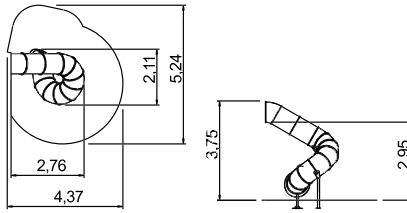
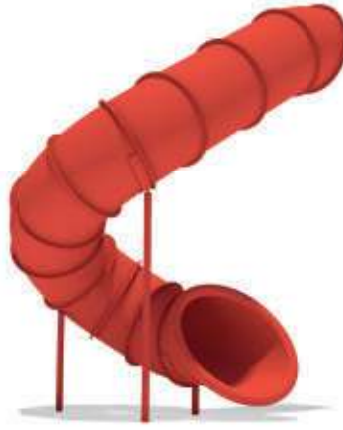

Spiral slide 270 degrees spiral right PH 295 cm

Info box

Minimum space:	437x524x475 cm
Free falling height:	23 cm
Impact protection net:	18,0 m ²
Foundations:	3x CF

5 40 118 101 26	GFRP red	FL 3
5 40 118 101 22	GFRP grey	FL 3
5 40 118 101 31	GFRP iguana	FL 3

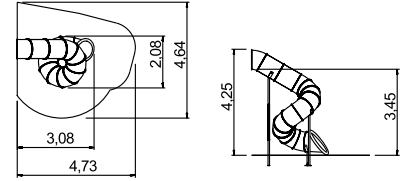

Spiral slide 360 degrees spiral right PH 345 cm

Info box

Minimum space:	473x464x525 cm
Free falling height:	15 cm
Impact protection net:	18,0 m ²
Foundations:	3x CF

5 40 122 101 26	GFRP red	FL 3
5 40 122 101 22	GFRP grey	FL 3
5 40 122 101 31	GFRP iguana	FL 3

NEW

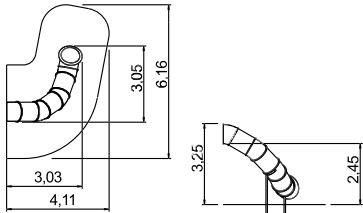
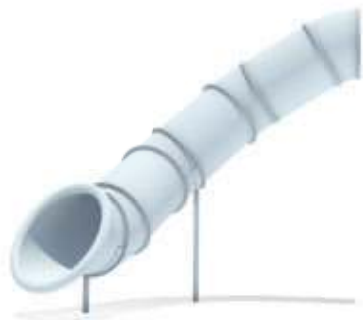

Spiral slide 120 degrees spiral left PH 245 cm

Info box

Minimum space:	411x616x425 cm
Free falling height:	30 cm
Impact protection net:	19,0 m ²
Foundations:	2x CF

5 40 119 101 26	GFRP red	FL 3
5 40 119 101 22	GFRP grey	FL 3
5 40 119 101 31	GFRP iguana	FL 3

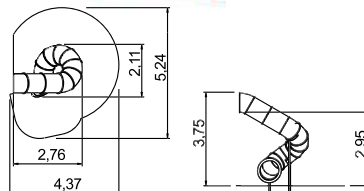

Spiral slide 270 degrees spiral left PH 295 cm

Info box

Minimum space:	437x524x475 cm
Free falling height:	23 cm
Impact protection net:	18,0 m ²
Foundations:	3x CF

5 40 120 101 26	GFRP red	FL 3
5 40 120 101 22	GFRP grey	FL 3
5 40 120 101 31	GFRP iguana	FL 3

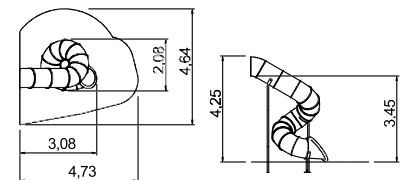

Spiral slide 360 degrees spiral left PH 345 cm

Info box

Minimum space:	473x464x525 cm
Free falling height:	15 cm
Impact protection net:	18,0 m ²
Foundations:	3x CF

5 40 121 101 26	GFRP red	FL 3
5 40 121 101 22	GFRP grey	FL 3
5 40 121 101 31	GFRP iguana	FL 3

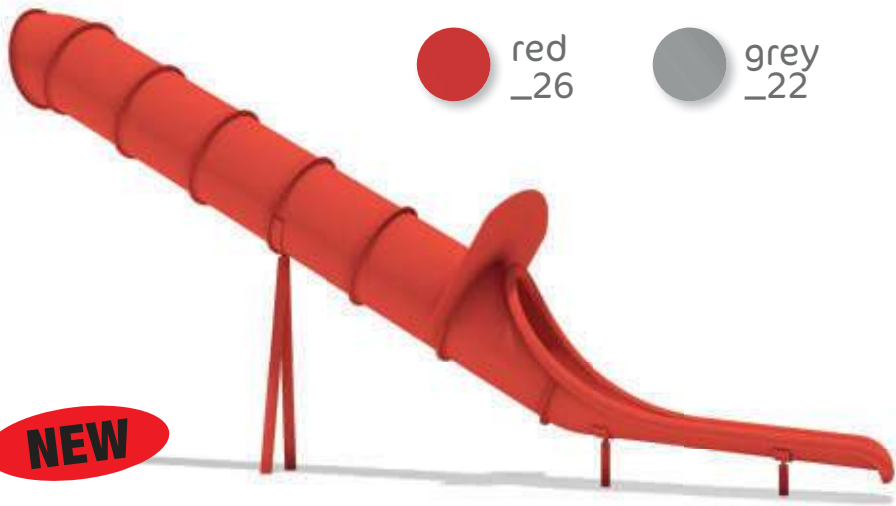

 red
_26

 grey
_22

 RAL iguana
_31

NEW

Tube attachment slide

Info box

Minimum space:	775x380x475 cm
Free falling height:	30 cm
Impact protection net:	24,0 m ²
Foundations:	3x CF

5 40 116 101 26	GFRP red	FL 3
5 40 116 101 22	GFRP grey	FL 3
5 40 116 101 31	GFRP iguana	FL 3

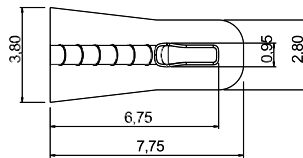
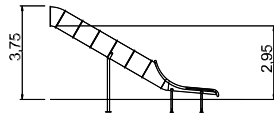

NEW

Climb over protection for tube slides

5 40 199 150 26	HPL red
5 40 199 150 22	HPL grey
5 40 199 150 31	HPL iguana





Installation frame included



**Ground trampoline Jump
round Ø 170 cm**

Info box

Minimum space: Ø 420 cm
 Free falling height: 1,00 m
 Impact protection net: 8 m²
 Foundations:

5 62 111 0

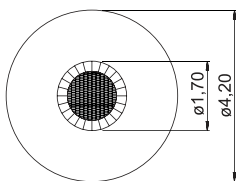

**Ground trampoline Jump
XL 2x3m**

Info box

Minimum space: 450x550x cm
 Free falling height: 1,00 m
 Impact protection net: 18,75 m²
 Foundations:

5 62 110 0

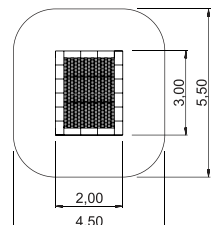



A real highlight for your playground, kindergarten, and school yard!

Your benefits at a glance:

- suitable for playgrounds, GS certified (DIN EN1176)
- highest safety and quality standards
- also ideal for use in non-supervised play areas
- promotes the development of coordination and motor skills in children
- vandalism-proof (if equipped with vandalism-proof jumping sheet)
- easy transport and installation, with instruction video
- 100% made in Germany for more than 50 years
- different sizes, shapes, and versions
- perfect for combination of several trampolines
- attractive price



The jumping sheet is highly vandalism-proof owing to the wire reinforced sides and centre of the fabric. Particularly suitable for non-supervised play areas.



Floor trampoline, Vandalism-proof

Material: Jump mat: wire-reinforced belt material, steel springs, rubber granulate

Floor trampoline Kids Tramp Playground 150x150 cm

5 62 100 0

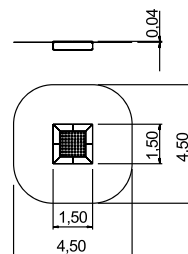

Floor trampoline Kids Tramp Playground 200x200 cm

5 62 101 0

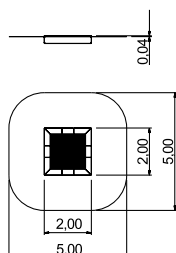

Installation frame included



Length 200 cm
 Seat height 42 cm
 Seat depth 41 cm
 Backrest height 78 cm



Size: 200 x 60 cm



Park bench Monika

5 60 030 0 Steel, SW pi

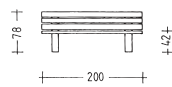
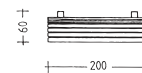

Table for park bench Monika

5 60 088 0 Steel, SW pi



NEW



Size: 200x151x86 cm,

Seat height 45 cm, Table height 70 cm

Picnic bench Erzgebirge

5 60 356 0 Framework: hot dip galvanised and powder coated steel
 Seat / Table top: Iroko wood

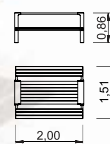

NEW

Park bench Frankenhöhe with backrest

5 60 354 0 Framework: hot dip galvanised and powder coated steel
 Seat: Iroko wood

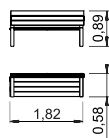

Size: 182x58x89 cm,

Seat height 45 cm

NEW

Park bench Frankenhöhe without backrest

5 60 353 0 Framework: hot dip galvanised and powder coated steel
 Seat: Iroko wood

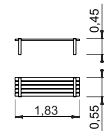

Size: 183x55x45 cm,

Seat height 45 cm



NEW

Size: 155x49x84 cm,
Seat height 45 cm

Park bench Altmühltal with backrest

5 60 346 0	Framework: Stainless steel
5 60 347 0	Table top Iroko wood
5 60 347 0	Framework and seating surface: Stainless steel

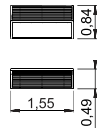

NEW

Size: 155x40x45 cm,
Seat height 45 cm

Park bench Altmühltal without backrest

5 60 344 0	Framework: Stainless steel
5 60 345 0	Table top Iroko wood
5 60 345 0	Framework and seating surface: Stainless steel

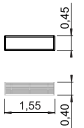

NEW

Size: 155x54x86 cm,
Seat height 50 cm

Park bench Lüneburger Heide with backrest

5 60 351 0	Framework: Stainless steel
5 60 352 0	Table top Iroko wood
5 60 352 0	Framework and seating surface: Stainless steel

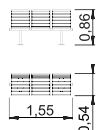

NEW

Size: 124x52x44 cm,
Seat height 45 cm

Park bench Saar without backrest

5 60 348 0	Framework: Stainless steel
5 60 349 0	Table top Iroko wood
5 60 349 0	Framework and seating surface: Stainless steel

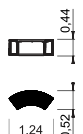

NEW

Size: 150x100x70 cm,
Table height 70 cm

Park table Taunus

5 60 350 0	Framework: Stainless steel
	Table top Iroko wood

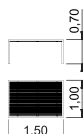

NEW

Size: 150x100x68 cm,
Table height 70 cm

Table Saale

5 60 355 0	Framework: hot dip galvanised and powder coated steel
	Table top: Iroko wood





Cartridge, 310 ml, black

Impact-attenuating tile glue

Impact attenuation plate glue ensures a lasting and secure attachment to concrete and asphalt surfaces.

5 63 033 0 PUR-adhesive



Safe in free fall

Proven quality

more than 40 years experience worldwide

environment friendly manufacture

maximum safety and long life due to homogenous and constant flexible structure of the fall protection panels pre-assembled connectors are used to secure the EUROFLEX® fall protection tiles against slipping and removal

excellent drainage due to the dome shaped underside

quick to install therefore low maintenance costs, permanent playability due to good permeability of the materials therefore cost effective

easy to trim allowing ideal fit around posts and supports

red-brown

green

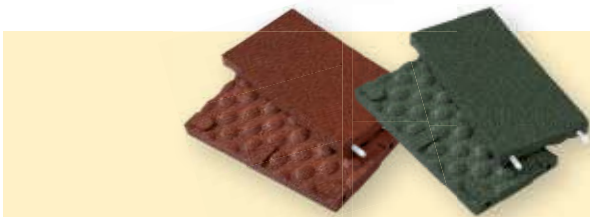

Half-tile safety slabs

25 x 50 cm

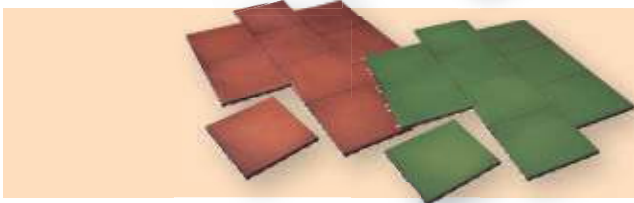

Standard safety slabs

50 x 50 cm



The professional transition between the surface and the impact-protection covering. Suitable for wheelchairs.

Edge impact attenuation tiles

100x25 cm



The professional crossover from the surface to the impact attenuation plates reduces the danger of tripping and allows wheelchairs to pass safely.

Corner edge impact attenuation tiles

100x25 cm

Impact protection for free falling heights 100 cm, 175 cm, 210 cm or 300 cm

Tile thicknesses for respective falling heights

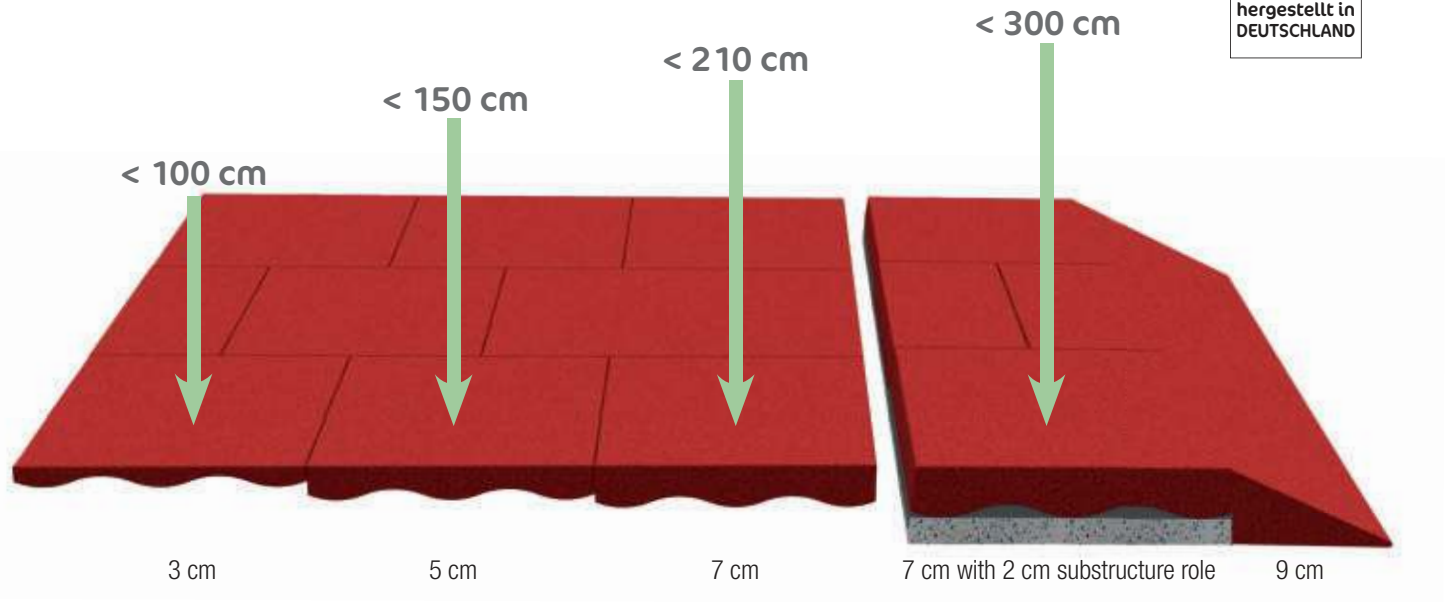

Layout of substructure



1. Compact the underground
2. Base layer, depending on situation on site, approx. 15 cm gravel
3. Setting bed, approx. 3 cm chippings
4. Impact attenuation tiles
5. Borders
6. Connection at ground level

Impact zone

Overview on the required shock attenuation in the impact zone pursuant to DIN EN-1176-1.

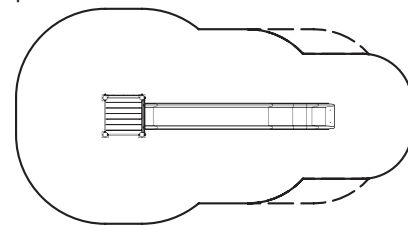

dotted line: impact zone without impact attenuation
 continuous line: impact zone with impact attenuation

Falling height < 100 cm	Falling height < 150 cm	Falling height < 210 cm	Falling height < 300 cm
Half-tile 25x50x3 cm Scope of delivery: 1 sqm 5 63 565 0 red-brown 5 63 565 50 green	Standard slab 50x50x6 cm Scope of delivery: 1 sqm 5 63 580 0 red-brown 5 63 580 50 green	Half-tile 25x50x3 cm Scope of delivery: 1 sqm 5 63 567 0 red-brown 5 63 567 50 green	
Standard slab 50x50x3 cm Scope of delivery: 1 sqm 5 63 539 0 red-brown 5 63 551 0 green	Standard slab 50x50x6 cm Scope of delivery: 1 sqm 5 63 579 0 red-brown 5 63 579 50 green	Standard slab 50x50x7 cm Scope of delivery: 1 sqm 5 63 541 0 red-brown 5 63 554 0 green	Standard slab 50x50x9 cm Scope of delivery: 1 sqm including substructure role 5 63 569 0 red-brown 5 63 569 50 green
Corner slab 100x25x3 cm Scope of delivery: 1 tile 5 63 560 0 red-brown 5 63 560 50 green	Corner slab 100x25x2/5 cm Scope of delivery: 1 tile 5 63 543 0 red-brown 5 63 543 50 green	Corner slab 100x25x2/7 cm Scope of delivery: 1 tile 5 63 544 0 red-brown 5 63 544 50 green	Corner slab 100x25x2/9 cm Scope of delivery: 1 tile 5 63 571 0 red-brown 5 63 571 50 green
Outer corner slab 100x25x3 cm Scope of delivery: 1 tile 5 63 561 0 red-brown 5 63 564 50 green	Outer corner slab 100x25x2/5 cm Scope of delivery: 1 tile 5 63 546 0 red-brown 5 63 546 50 green	Outer corner slab 100x25x2/7 cm Scope of delivery: 1 tile 5 63 547 0 red-brown 5 63 547 50 green	Outer corner slab 100x25x2/9 cm Scope of delivery: 1 tile 5 63 573 0 red-brown 5 63 573 50 green

ORDER SEPARATELY

simple and fast installation with the eibe prefabricated foundation



Fast and easy assembly

Save time & money with eibe prefabricated foundations

eibe prefabricated foundations save time and money: little excavation, quick installation, no waiting time



380 kg

FFg

Prefabricated foundation plate

5 63 073 0 Concrete -



45 kg

FFk

Prefabricated foundation, small

5 63 070 0 Concrete -

Can also be used as ground anchor 1



1

① Concrete Foundation for eibe basis Spring Rockers

All eibe basic spring rockers are securely mounted with their concrete-prefabricated baseplate. The attachment screws for the spiral spring are preset in concrete.

5 59 160 0 Concrete -

2



② Ground Anchor for eibe Spring Rockers 1

The spring rocker is attached on a stable ground anchor with a baseplate made of corrosion-proof steel. We strongly advise that eibe basic spring rockers which are in frequent use should be set in concrete.

5 63 210 0 Steel -

Play values



Running, climbing, jumping, dancing, romping, gymnastics, hand-over-hand climbing, crawling



Communication, playing together, meeting



Playing with water, sand, mud, natural materials



Making music, singing, creating sounds



Building, constructing



Crafting, painting, designing, working with tools



Touching, hearing, seeing, concentrating



Reading, arithmetic, writing, counting



Balancing, rocking



Experimenting, studying, observing



Togetherness



Doing puzzles, threading beads, promoting co-ordination



Sorting, arranging, keeping things safe



Resting, laying down, unwinding



Throwing, catching, batting, shooting, juggling



Social Integration



Sliding, swinging, rocking, turning, driving



Recommended age group

Labels

Consulting. Design. Cost effective.

**CONSULTING
ON SITE**

ORDER
SEPARATELY

NEW

Impact zone

Overview on the required shock attenuation in the impact zone pursuant to DIN EN-1176-1.

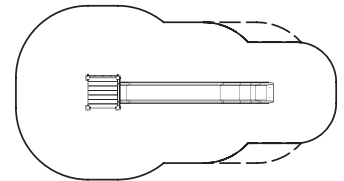

dotted line: impact zone without impact attenuation
continuous line:
impact zone with impact attenuation

Abbreviations in the catalogue

SW:	softwood	PA:	polyamide
GL:	glued-laminated timber	PVC:	polyvinyl chloride
PI:	pressure-impregnated	PH:	platform height
RAL:	RAL quality mark for wood preservation agent	SH:	seat height
MDF:	medium dense fibre board	TH:	table height
HPL:	high-pressure laminate	CF:	concrete foundation
GFRP:	glass fibre reinforced plastic	PFS:	prefabricated foundation small
PP:	polypropylene	PFR:	prefabricated foundation round
VA, V2A:	stainless steel	PFL:	prefabricated foundation large
PE:	polyethylene	L:	length
PU:	polyurethane	W:	width
PPM:	polypropylene multifill	H:	height
PAH:	polycyclic aromatic hydrocarbons	D:	diameter

An overview of the foundation levels

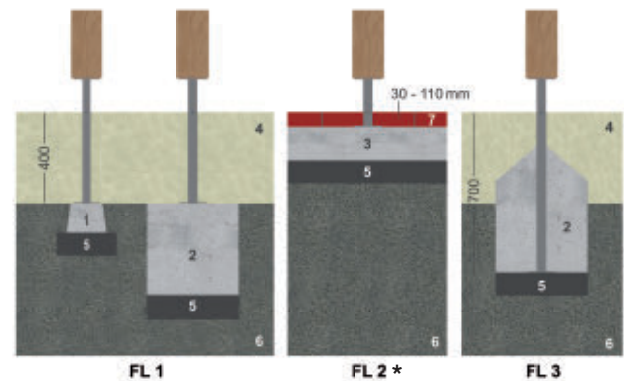

- 1 Prefabricated foundation
- 2 Cast foundation
- 3 Concrete floor plate
- 4 Loose impact attenuation, e.g. sand
- 5 Base layer, approx. 10 cm gravel
- 6 Underground
- 7 Impact attenuation tiles

* on request